

SYLVANIA

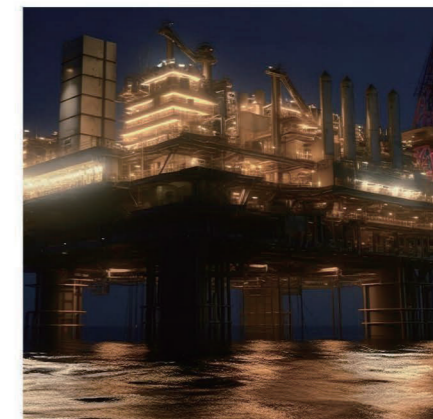

PRODUCTS FOR HAZARDOUS AND HARSH LOCATIONS

Safe / Reliable / Efficient

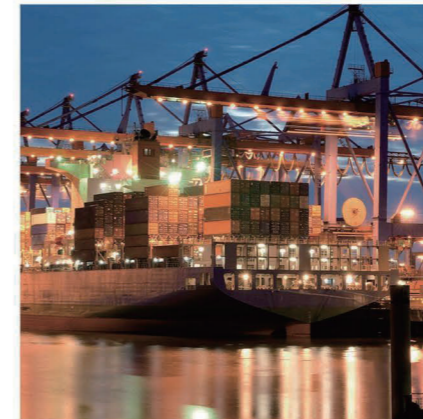

19A Cong Hoa Street, Bay Hien Ward, Ho Chi Minh City
Tel: 028-3811 0510 / 11, Email: info@vtltech.com.vn
Fax: 028-3811 0512 Website: www.vtltech.com.vn

Class I Division 1

Explosion-proof Light

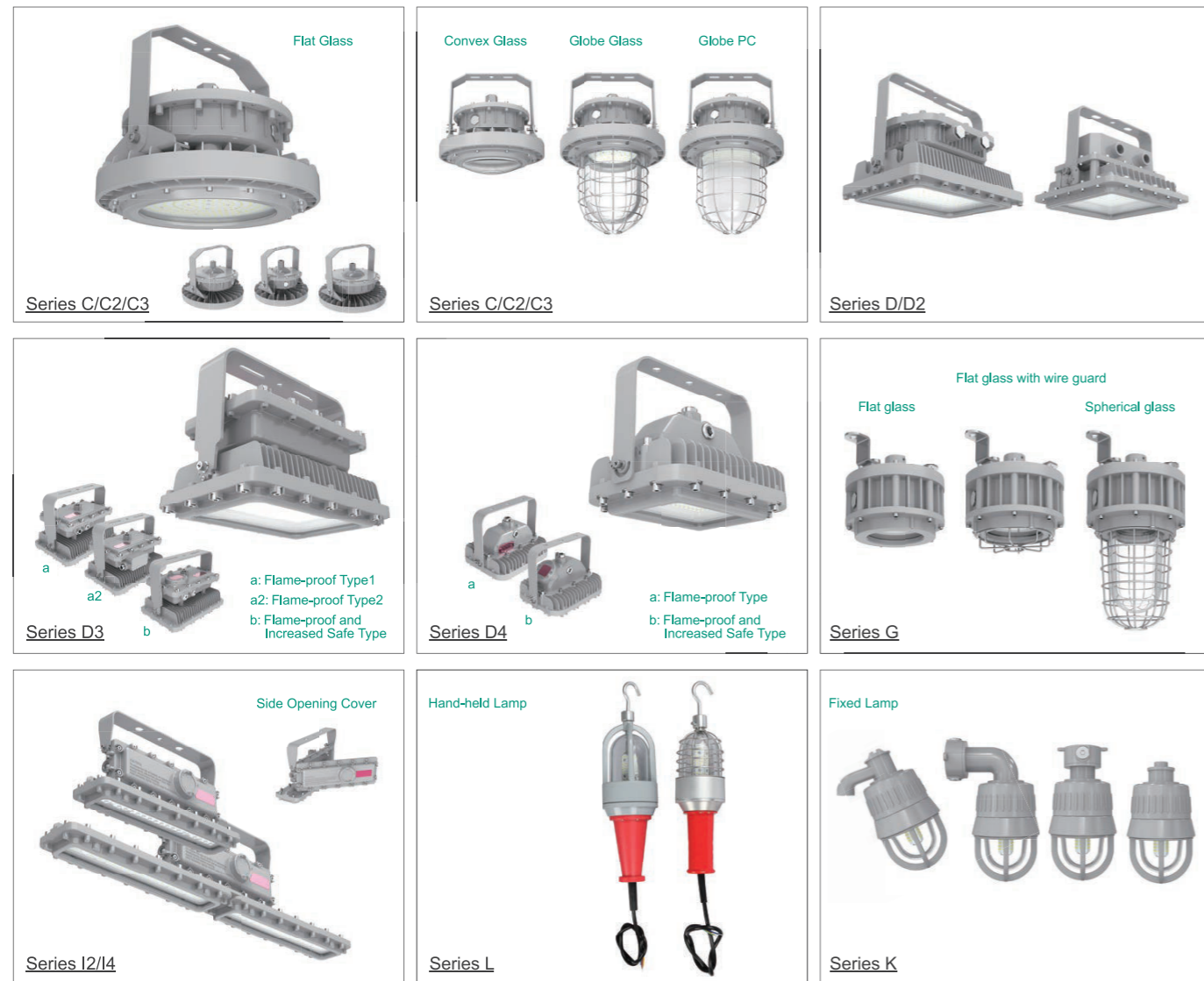
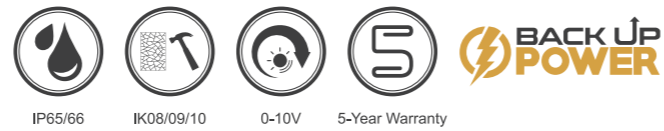

Model Number	C/C2/C3	D/D2/D3/D4	G	I2/I4	L	K
Wattage	20W - 80W (C2) 100W - 220W (C) 200W - 280W (C3)	20W - 80W (D2) 100W - 220W (D) 80W - 280W (D3) 20W - 100W (D4)	10W - 40W	20W - 100W (I2) 40W - 200W (I4)	5W/10W (for LED Bulbs) 20W/30W/40W (for Incandescent Lamp)	5W/10W (for LED Bulbs) 15W/20W/40W (for Incandescent Lamp)
Efficiency	140lm/W	140lm/W(D/D2) 140lm/W-170lm/W (D3/D4)	114lm/W (10W-20W) 110lm/W (30W-40W)	130lm/W	100lm/W	100lm/W
Hazardous Ratings	CID1/CID2/CIID1/ CIID2/CIII	CID1/CID2/CIID1/ CIID2/CIII	CID1/CID2/CIID1/ CIID2/CIII	CID1/CID2/CIID1/ CIID2/CIII	CID1/CID2/CIID1/ CIID2/CIII	CID1/CID2/CIID1/ CIID2/CIII

Class I Division 1

Explosion-proof Light

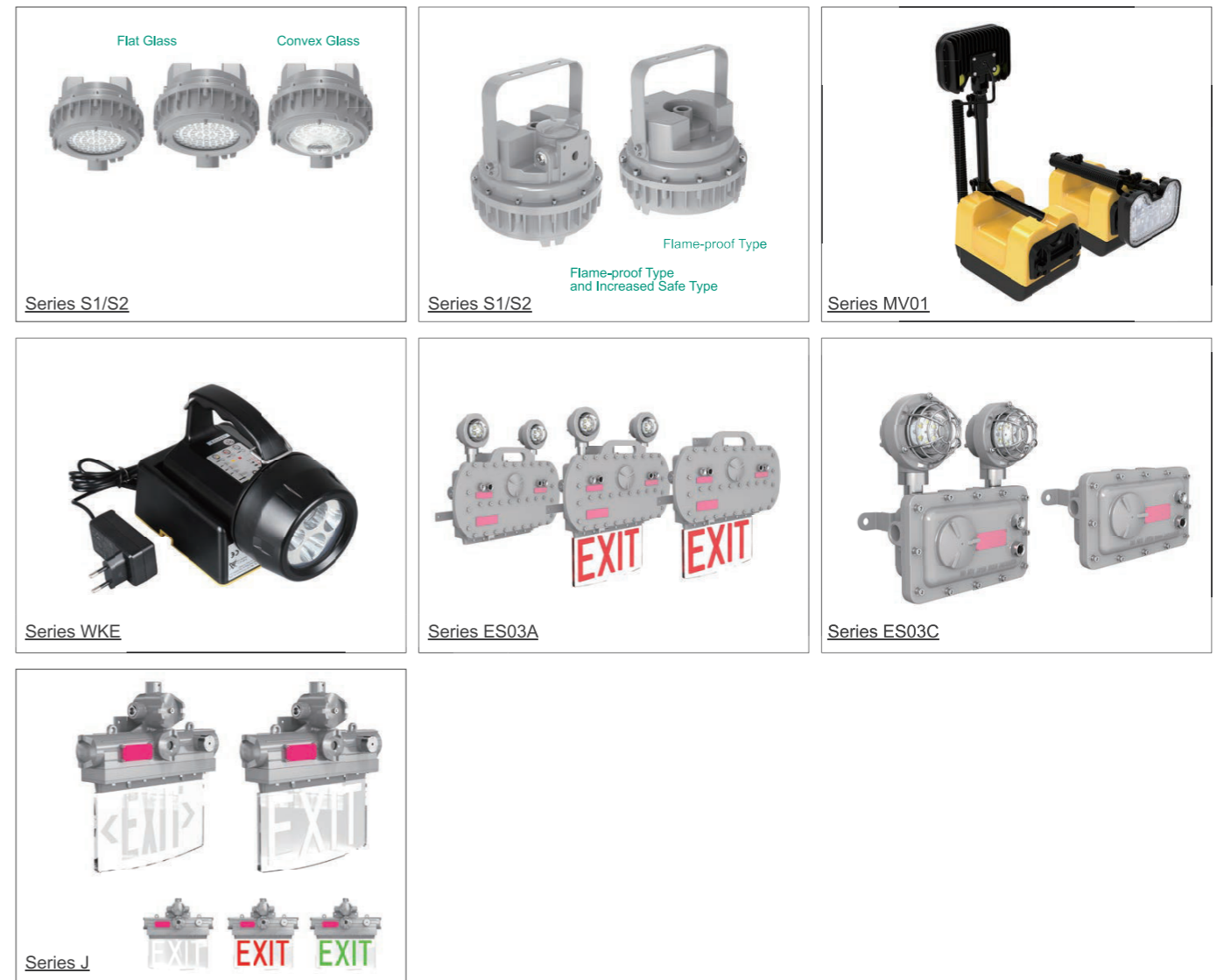
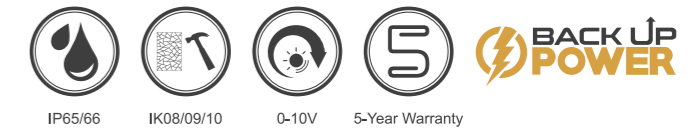

Model Number	S1/S2	MV01	WKE	ES03A	ES03C	J
Wattage	20 - 100W (S1) 100 - 240W (S2)	5W - 19.5W	2W	5W - 20W	8W - 10W	1W - 5W
Efficiency	140lm/W	xxx	xxx	xxx	xxx	xxx
Hazardous Ratings	CID1/CID2/CIID1/ CIID2/CIII	CID1/CID2/CIID1/ CIID2/CIII	CID1/CID2/CIID1/ CIID2/CIII	CID1/CID2/CIID1/ CIID2/CIII	CID1/CID2/CIID1/ CIID2/CIII	CID1/CID2/CIID1/ CIID2/CIII

Class I Division 2

Explosion-proof Light

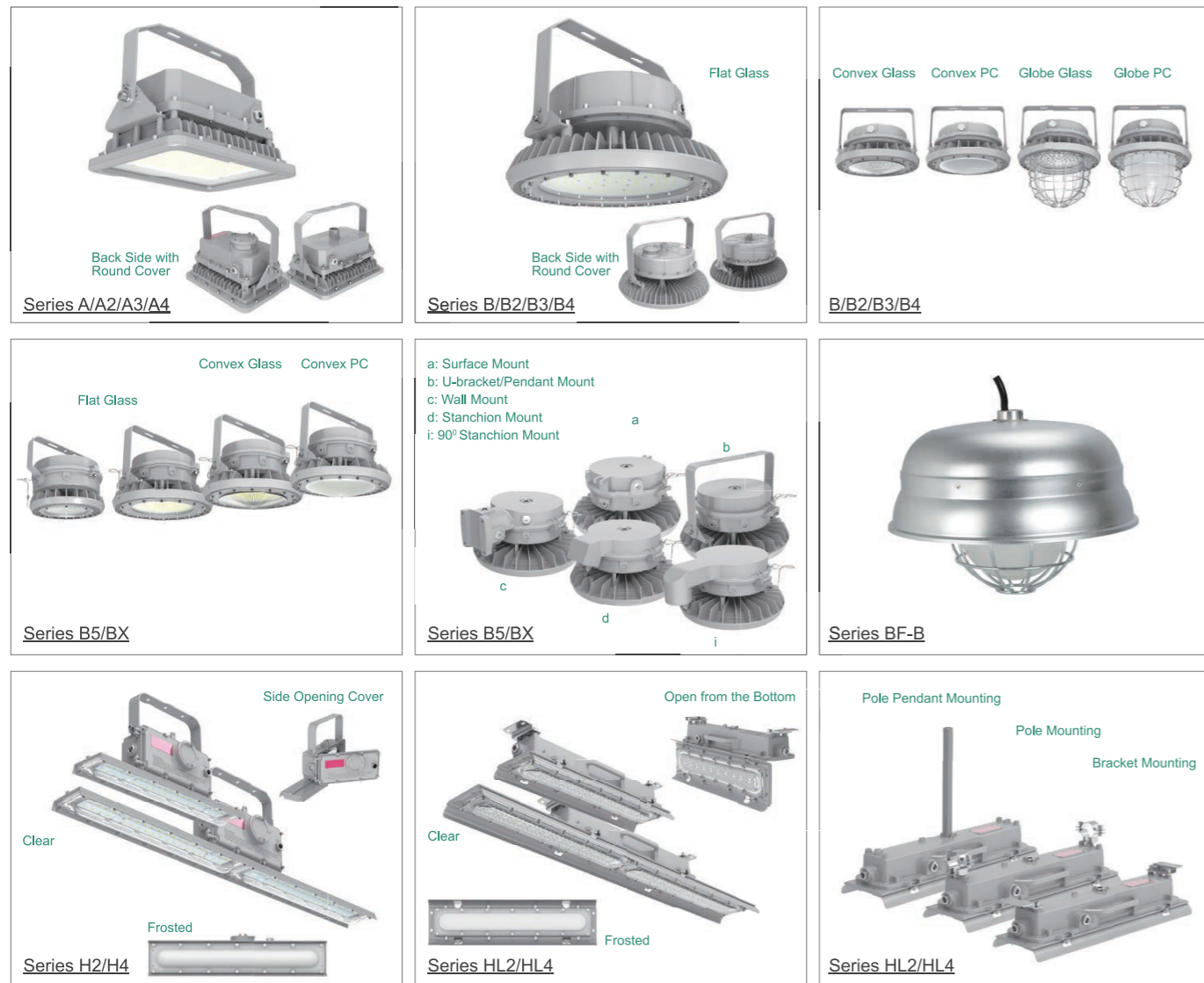
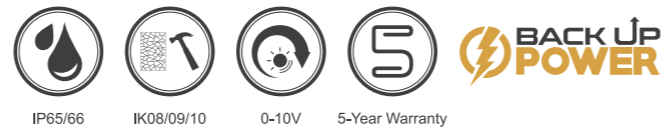

Model Number	A/A2/A3/A4	B/B2/B3/B4	B5/BX	BF-B	H2/H4	HL2/HL4
Wattage	20W - 80W (A2) 60W - 150W (A) 120W - 240W (A3) 250W - 450W (A4)	20W - 80W (B2) 20W - 150W (B) 20W - 240W (B3) 150W - 450W (B4)	20W - 150W (B5) 20W - 240W (BX)	20W - 100W	20W - 100W (H2) 40W - 200W (H4)	20W - 100W (HL2) 40W - 200W (HL4)
Efficiency	170lm/W	170lm/W	160lm/W	160lm/W	150lm/W	150lm/W
Hazardous Ratings	CID2/CIID1/ CIID2/CIII	CID2/CIID1/ CIID2/CIII	CID2/CIID1/ CIID2/CIII	CID2/CIID1/ CIID2/CIII	CID2/CIID1/ CIID2/CIII	CID2/CIID1/ CIID2/CIII

Class I Division 2

Explosion-proof Light

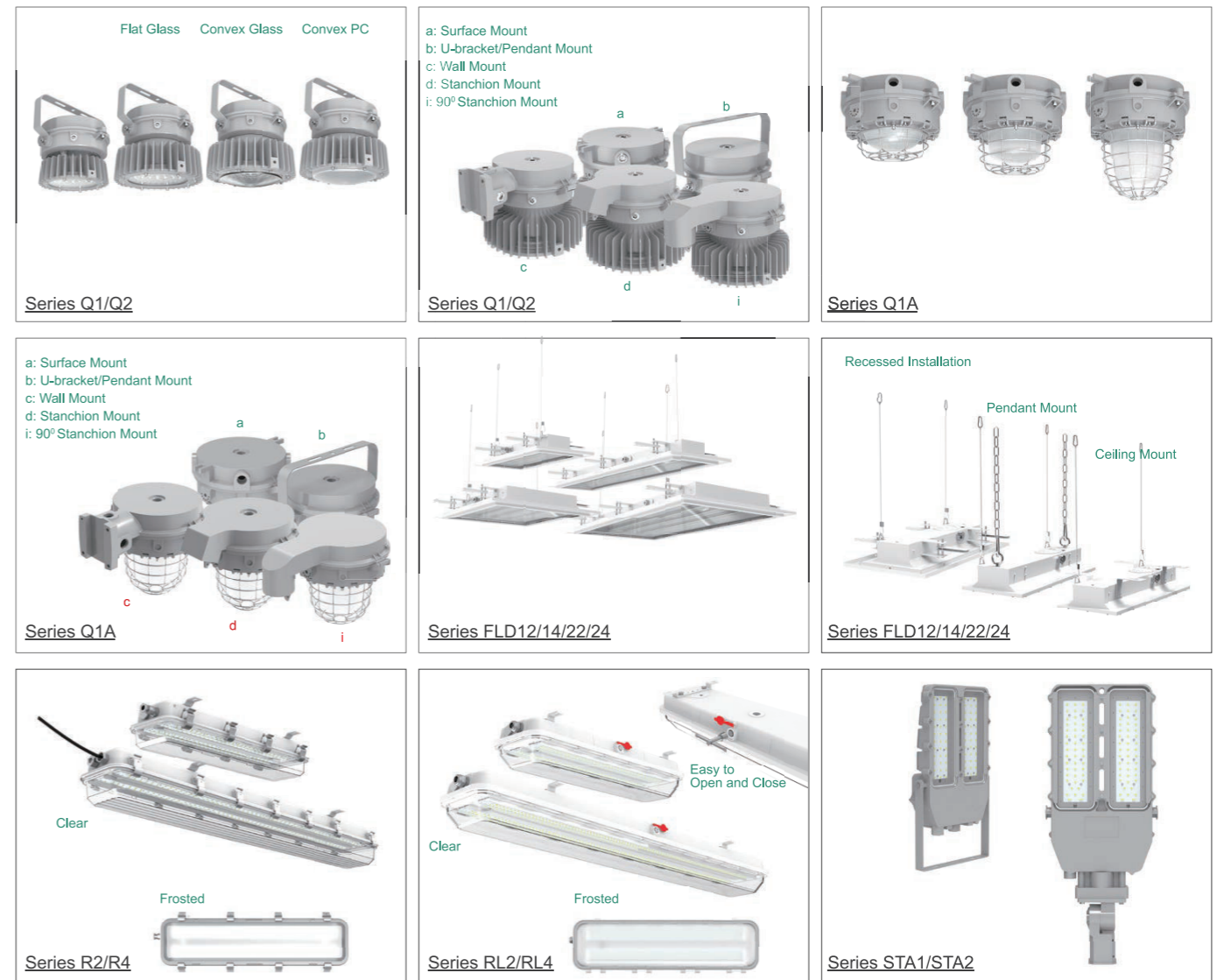
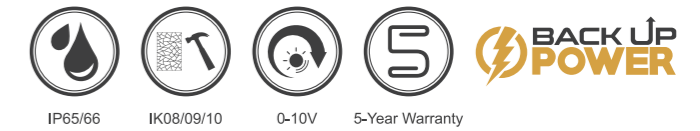

Model Number	Q1/Q2	Q1A	FLD12/14/22/24	R2/R4	RL2/RL4	STA1/STA2
Wattage	20W - 150W (Q1) 20W - 200W (Q2)	20W - 60W	15W - 30W (FLD12) 15W - 60W (FLD14) 15W - 60W (FLD22) 15W - 120W (FLD24)	20W - 50W (R2) 30W - 80W (R4)	10W - 30W (RL2) 20W - 55W (RL4)	100W - 200W (STA1) 120W (STA2)
Efficiency	160lm/W 160lm/W (@240W)	150lm/W	160lm/W	150lm/W	150lm/W	140lm/W-150lm/W
Hazardous Ratings	CID2/CIID1/ CIID2/CIII	CID2/CIID1/ CIID2/CIII	CID2/CIID1/ CIID2/CIII	CID2/CIID1/ CIID2/CIII	CID2/CIID1/ CIID2/CIII	CID2/CIID1/ CIID2/CIII

Class I Division 2

Explosion-proof Light

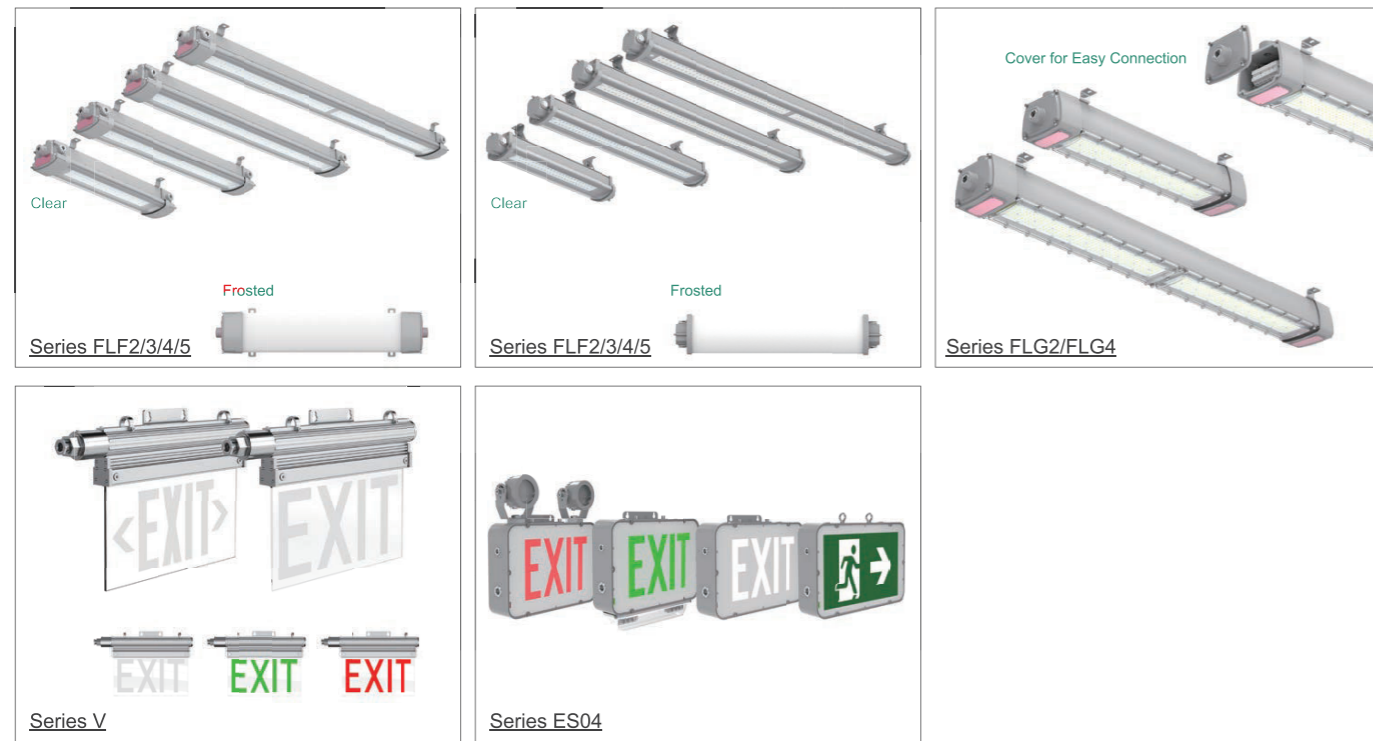
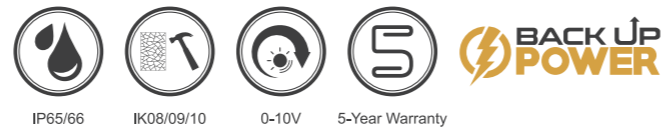

Model Number	FLF2/3/4/5	FLG2/FLG4	V	ES04
Wattage	20W - 40W (FLF2) 20W - 60W (FLF3) 20W - 80W (FLF4) 20W - 100W (FLF5)	20W - 70W (FLG2) 50W - 140W (FLG4)	5W	6W - 10W
Efficiency	150lm/W - 160lm/W	180lm/W (with lens) 190lm/W	xxx	xxx
Hazardous Ratings	CID2/CIID1/ CIID2/CIII	CID2/CIID1/ CIID2/CIII	CID2/CIID1/ CIID2/CIII	CID1/CIID2/CIII Zone 1/2 Zone 21/22

Zone 0&1&2

Explosion-proof Light

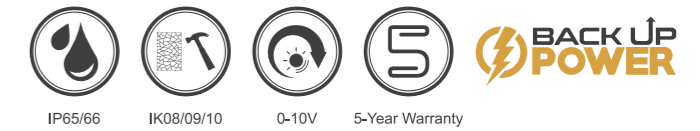

Model Number	B&Junction Box	SS1	SS2	WKE	WKG	MV01
Wattage	20W - 400W	30W - 50W	30W - 50W	2W (Strong Light) 1W (Work Light)	2W (Strong Light) 1W (Work Light)	20W - 100W
Efficiency	140lm/W	110lm/W	110lm/W	130lm/W 120lm/W (@200W)	130lm/W 120lm/W (@200W)	
Hazardous Ratings	Zone 1/2 Zone 21/22	Zone 1/2 Zone 21/22	Zone 1/2 Zone 21/22	M1 Underground Zone 0/1/2 Zone 21/22	M1 Underground Zone 0/1/2 Zone 21/22	Zone 0/1/2 Zone 21/22

Zone 1&2

Explosion-proof Light

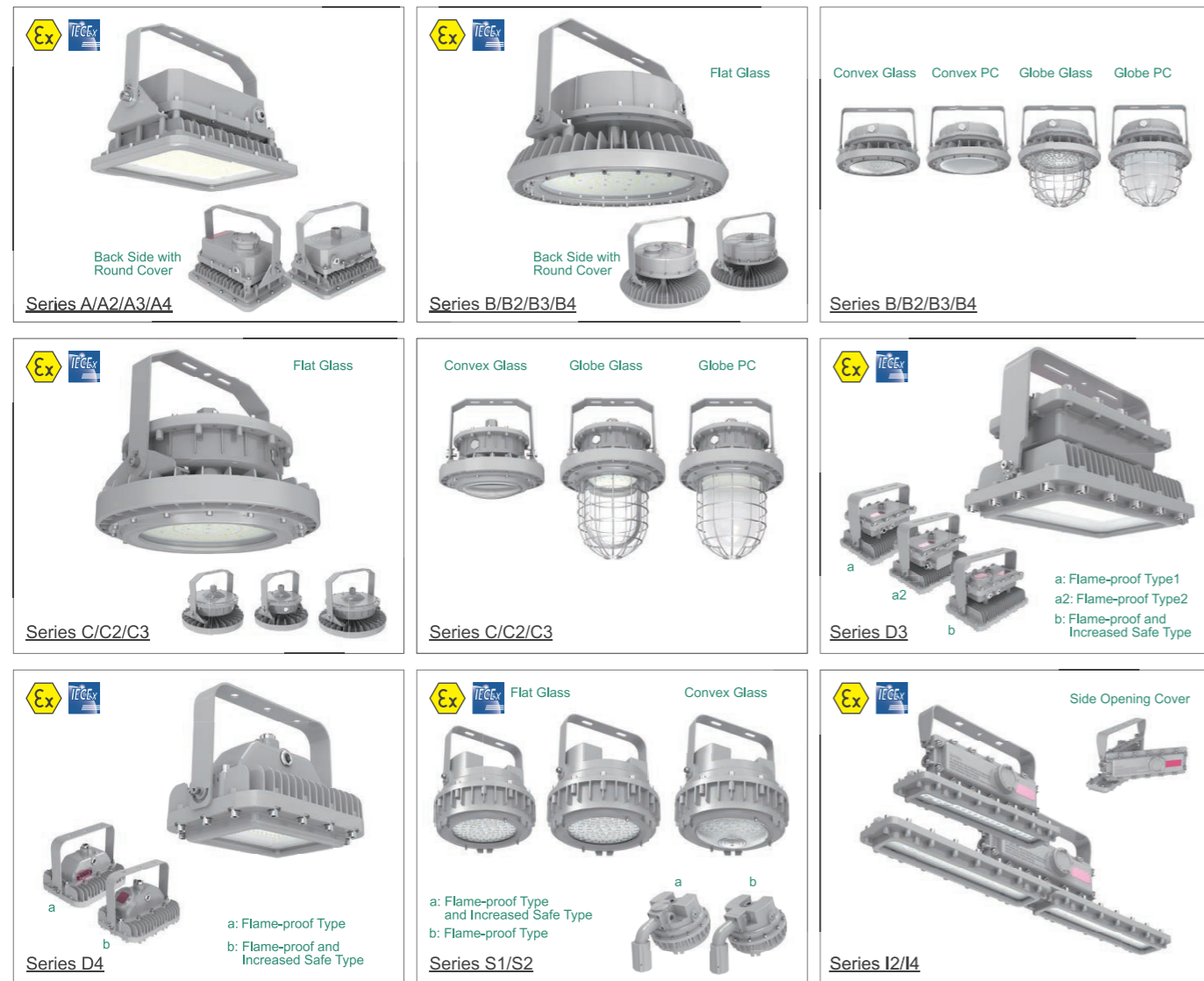
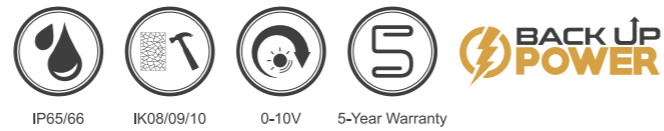

Model Number	A/A3/A4	B/B3/B4	C/C2/C3	D3/D4	S1/S2	I2/I4
Wattage	60W - 150W (A) 120W - 240W (A3) 250W - 450W (A4)	60W - 150W (B) 120W - 240W (B3) 250W - 450W (B4)	20W - 80W (C2) 100W - 220W (C) 200W - 280W (C3)	20W - 100W (D4) 80W - 280W (D3)	20W - 100W (S1) 100W - 240W (S2)	50W - 100W (I2) 80W - 150W (I4)
Efficiency	130lm/W(Zone 1) 170lm/W(Zone 2)	130lm/W(Zone 1) 170lm/W(Zone 2)	140lm/W	140lm/W-170lm/W	140lm/W	140lm/W
Hazardous Ratings	Zone 1&2, Zone 21&22	Zone 1&2, Zone 21&22	Zone 1&2, Zone 21&22	Zone 1&2, Zone 21&22	Zone 1&2, Zone 21&22	Zone 1&2, Zone 21&22

Zone 1&2

Explosion-proof Light

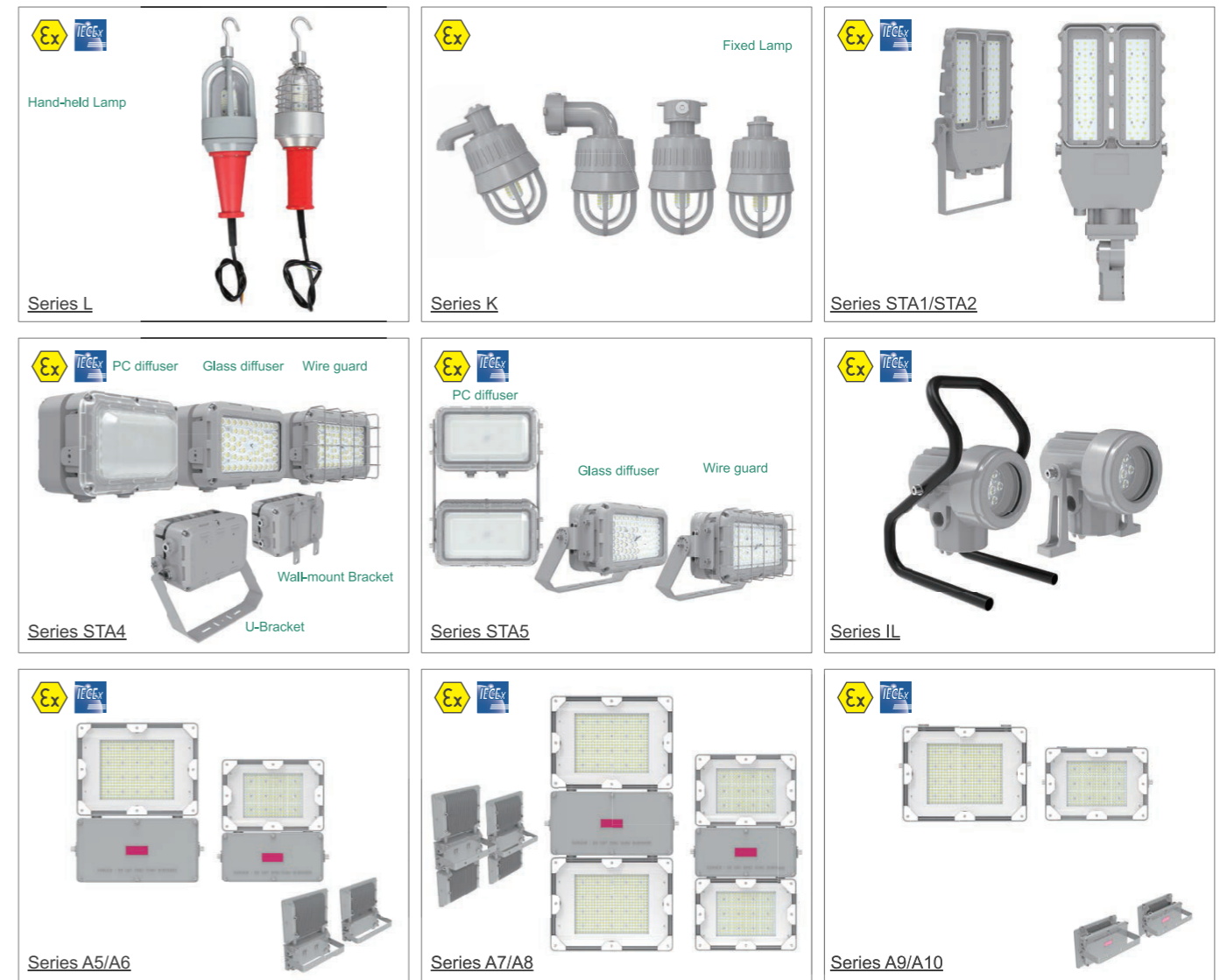
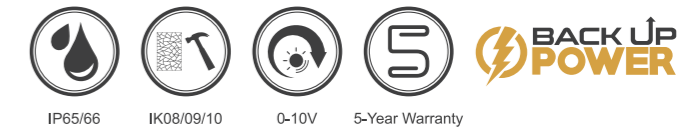

Model Number	L	K	STA1/2/4/5	IL	A5/A6A7/A8	A9/A10
Wattage	5W/10W (for LED Bulbs) 20W/30W/40W (for Incandescent Lamp)	5W/10W (for LED Bulbs) 15W/20W/40W (for Incandescent Lamp)	120W - 240W (STA1) 50W - 120W (STA2) 30W - 60W (STA4) 30W - 60W (STA5) 50W - 100W (STA5)	5W - 12W	50W - 240W (A5) 50W - 120W (A6) 100W - 450W (A7) 100W - 240W (A8)	50W - 240W (A9) 50W - 120W (A10)
Efficiency	100lm/W	100lm/W	120lm/W - 140lm/W (STA1/2) 110lm/W - 130lm/W (STA4/5)	115lm/W	130lm/W (3500K-4000K) 140lm/W (4000K-6000K)	130lm/W (3500K-4000K) 140lm/W (4000K-6000K)
Hazardous Ratings	Zone 1&2, Zone 21&22	Zone 1&2, Zone 21&22	Zone 1&2, Zone 21&22	Zone 1&2, Zone 21&22	Zone 1&2, Zone 21&22	Zone 1&2, Zone 21&22

Zone 1&2

Explosion-proof Light

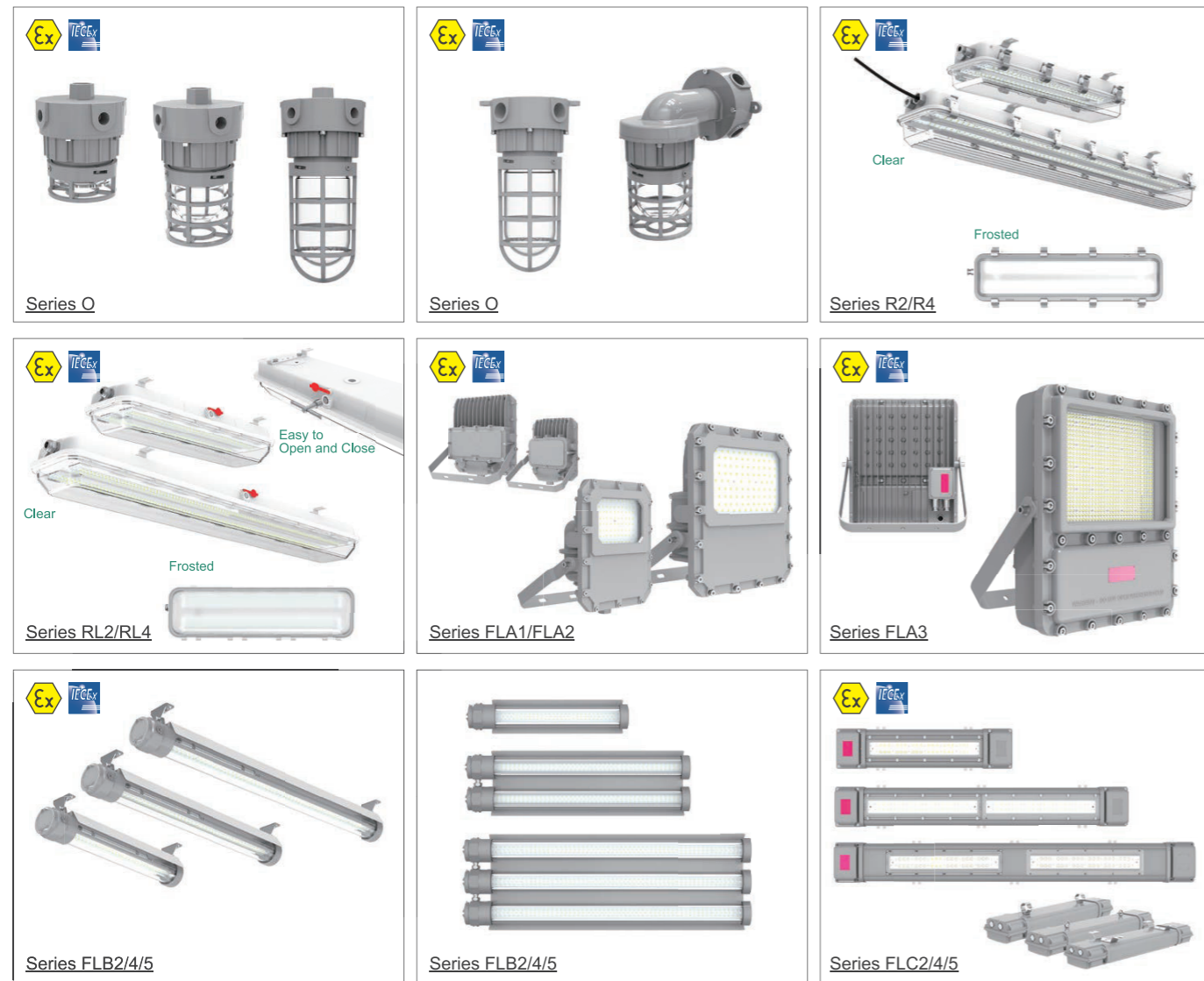
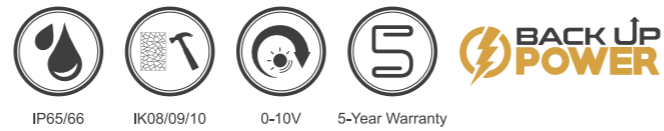

Model Number	O	R2/R4	RL2/RL4	FLA1/2/3	FLB2/4/5	FLC2/4/5
Wattage	10W - 27W	20W - 50W (R2) 30W - 80W (R4)	10W - 30W (RL2) 20W - 55W (RL4)	20W - 100W (FLA1) 50W - 200W (FLA2) 500W (FLA3)	3 X 20W (FLB2) 3 X 30W (FLB4) 3 X 40W (FLB5)	10W - 50W (FLC2) 20W - 100W (FLC4) 20W - 100W (FLC5)
Efficiency	100lm/W	130lm/W(Zone 1) 150lm/W(Zone 2)	130lm/W(Zone 1) 150lm/W(Zone 2)	130lm/W	133lm/W	130lm/W
Hazardous Ratings	Zone 1&2, Zone 21&22	Zone 1&2, Zone 21&22	Zone 1&2, Zone 21&22	Zone 1&2, Zone 21&22	Zone 1&2, Zone 21&22	Zone 1&2, Zone 21&22

Zone 1&2

Explosion-proof Light

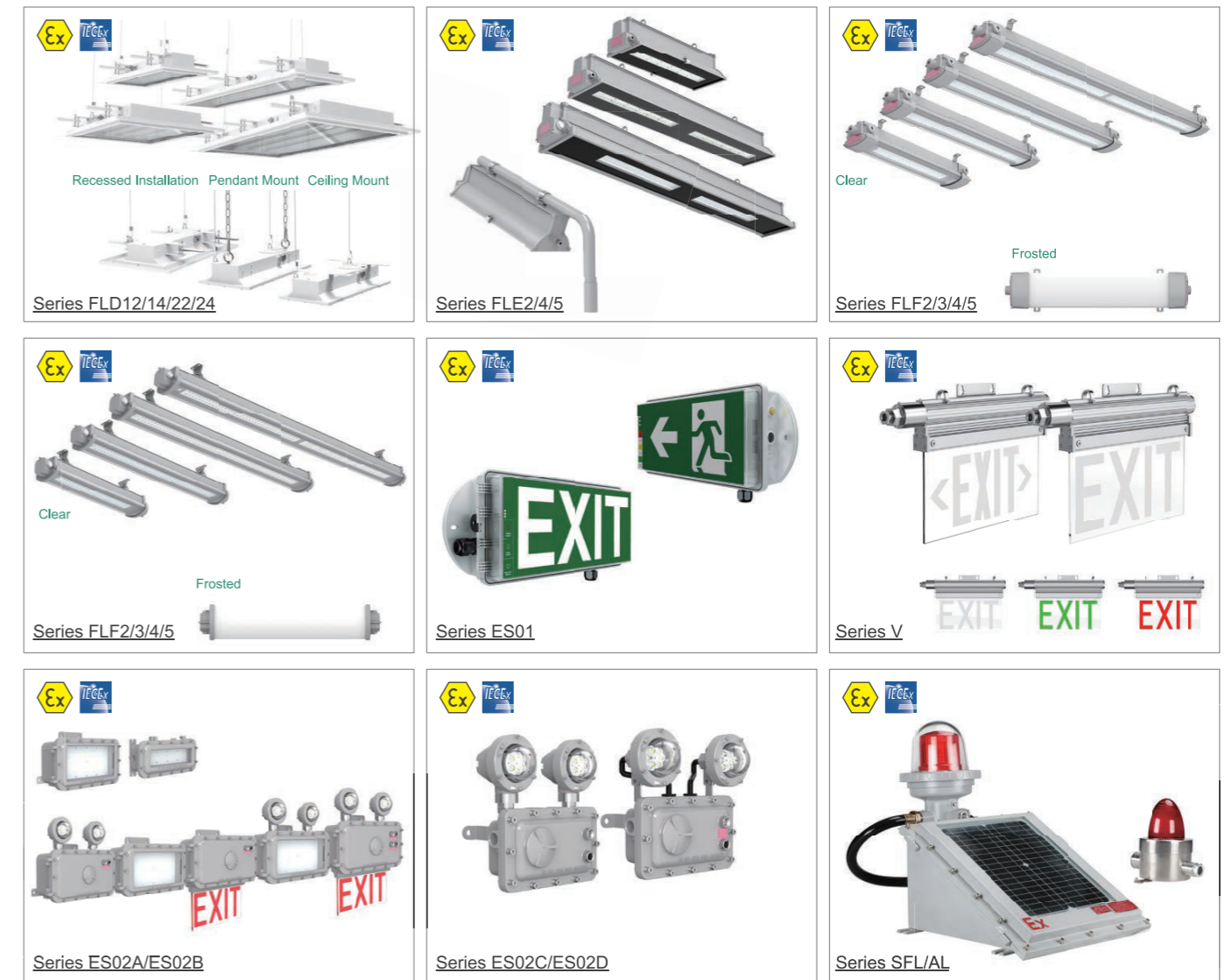
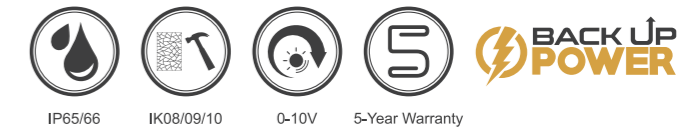

Model Number	FLD12/14/22/24	FLE2/4/5	FLF2/3/4/5	ES01/V	ES02A/B/C/D	SFL/AL
Wattage	15W - 50W (FL12) 15W - 90W (FL14) 15W - 90W (FL22) 15W - 180W (FL24)	10W - 40W (FLE2) 40W - 80W (FLE4) 60W - 100W (FLE5)	10W - 50W (FLF2) 20W - 60W (FLF3) 20W - 100W (FLF4) 20W - 100W (FLF5)	10W (ES01: Max) 3W (V: Max)	5W - 20W (ES02A) 3W - 15W (ES02B) 6W - 12W (ES02C) 6W - 12W (ES02D)	20W (SFL) 7W (AL)
Efficiency	120lm/W	130lm/W	108lm/W - 135lm/W	XXX	XXX	XXX
Hazardous Ratings	Zone 1&2, Zone 21&22	Zone 1&2, Zone 21&22	Zone 1&2, Zone 21&22	Zone 1&2, Zone 21&22	Zone 1&2, Zone 21&22	Zone 1&2, Zone 21&22

Zone 2

Explosion-proof Light

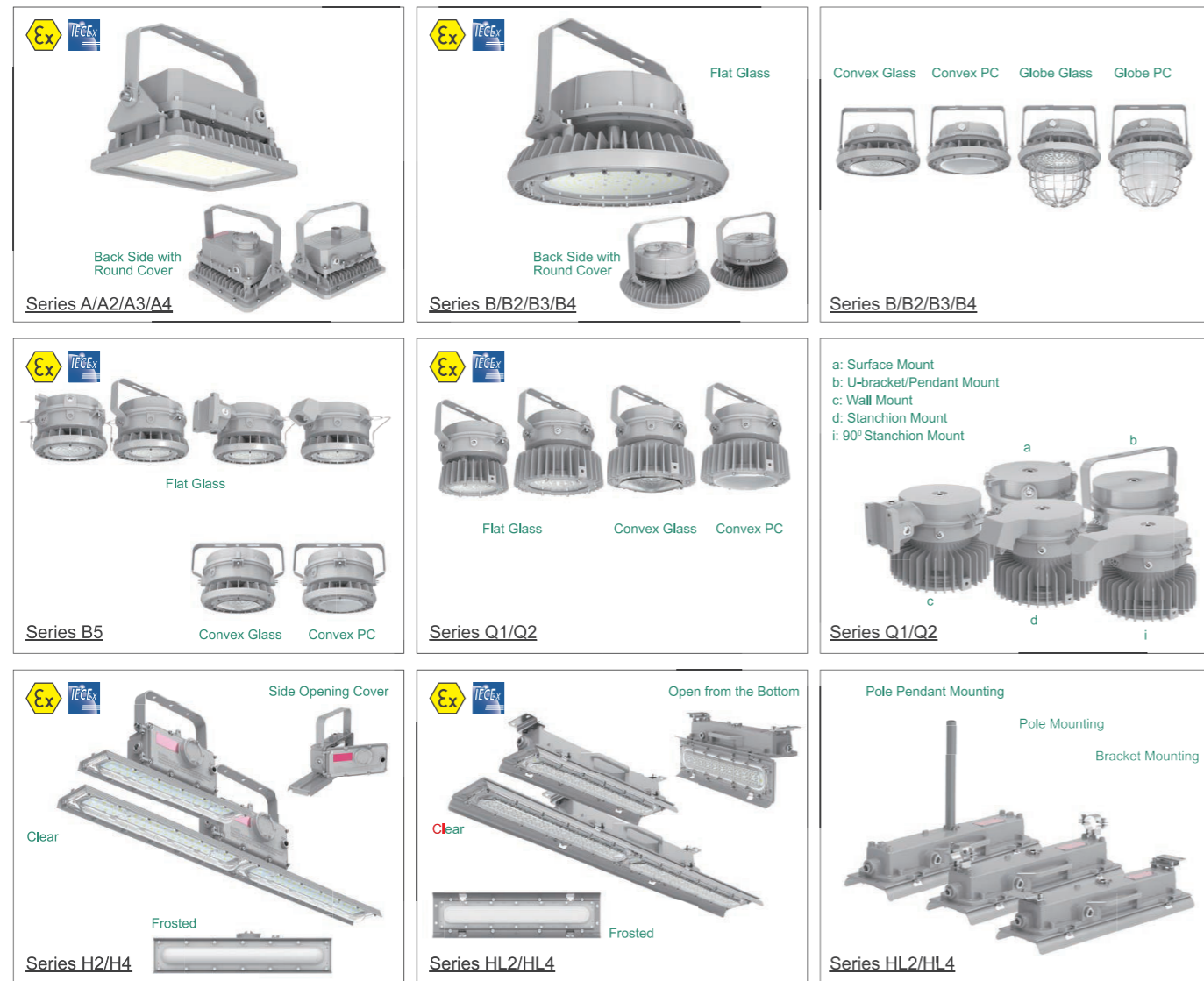
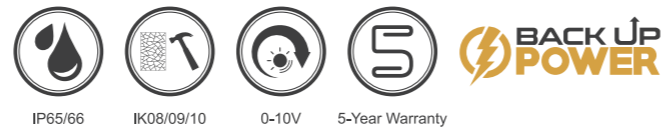

Model Number	A/A2/A3/A4	B/B2/B3/B4	B5	Q1/Q2	H2/H4	HL2/HL4
Wattage	20W - 80W (A2) 60W - 150W (A) 120W - 240W (A3) 250W - 450W (A4)	20W - 80W (B2) 20W - 150W (B) 20W - 240W (B3) 150W - 450W (B4)	20W - 150W	20W - 150W (Q1) 20W - 200W (Q2)	20W - 40W (H2) 40W - 80W (H4) 20W - 100W (New H2) 40W - 200W (New H4)	20W - 100W (HL2) 40W - 200W (HL4)
Efficiency	170lm/W	170lm/W	160lm/W	160lm/W	150lm/W	150lm/W
Hazardous Ratings	Zone 2, Zone 21&22	Zone 2, Zone 21&22	Zone 2, Zone 21&22	Zone 2, Zone 21&22	Zone 2, Zone 21&22	Zone 2, Zone 21&22

Zone 2

Explosion-proof Light

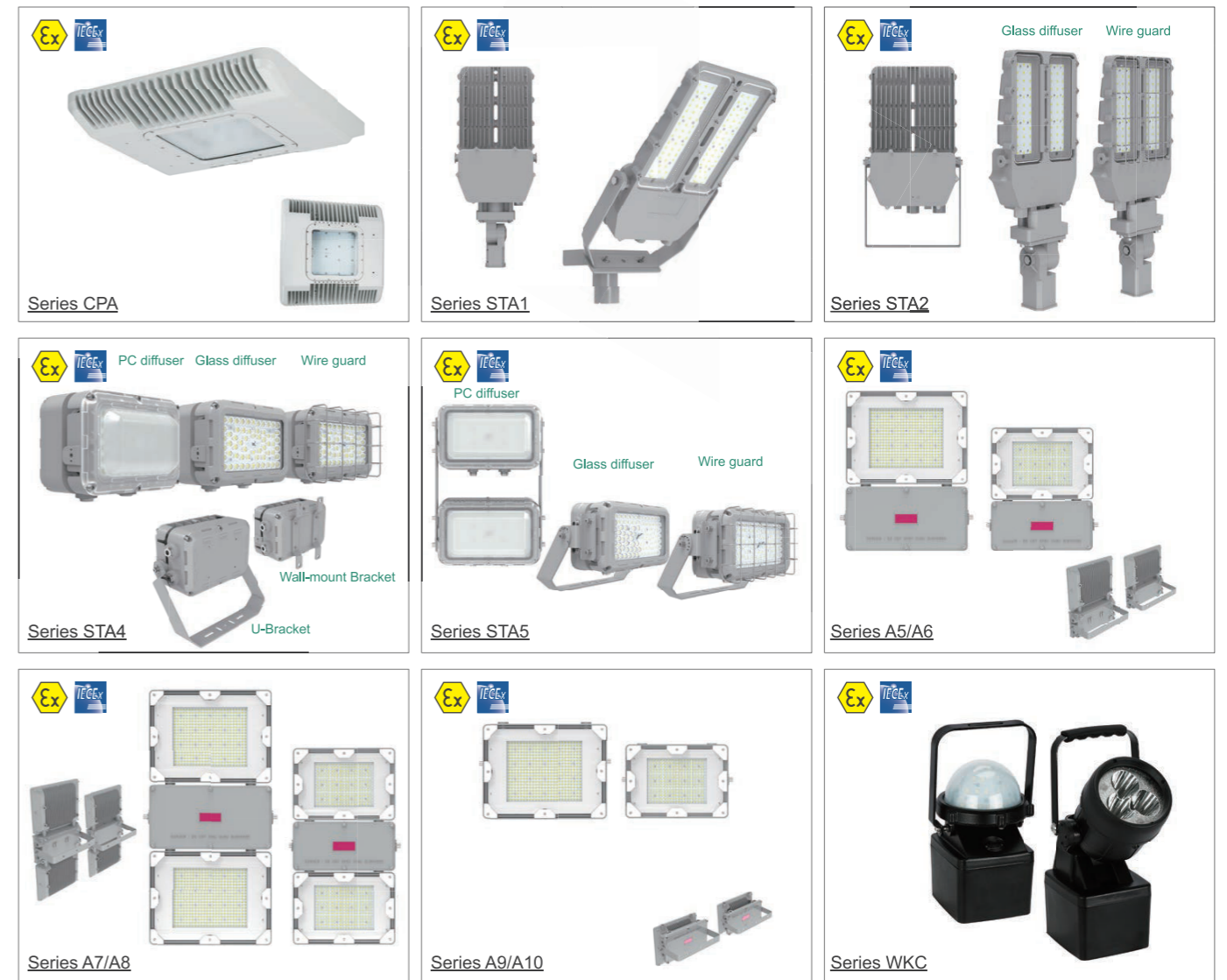
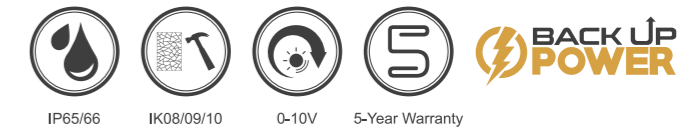

Model Number	CPA	STA1/2/4	A5/A6	A7/A8	A9/A10	WKC
Wattage	40W - 150W	120W - 240W (STA1) 50W - 120W (STA2) 30W - 60W (STA4)	50W - 240W (A5) 50W - 120W (A6)	100W - 450W (A7) 100W - 240W (A8)	50W - 240W (A9) 50W - 120W (A10)	10W (Max)
Efficiency	130lm/W	STA1/2 120lm/W - 140lm/W STA4 110lm/W - 130lm/W	150lm/W (3500K-4000K) 160lm/W (4000K-6000K)	150lm/W (3500K-4000K) 160lm/W (4000K-6000K)	150lm/W (3500K-4000K) 160lm/W (4000K-6000K)	XXX
Hazardous Ratings	Zone 2, Zone 21&22	Zone 2, Zone 21&22	Zone 2, Zone 21&22	Zone 2, Zone 21&22	Zone 2, Zone 21&22	Zone 2, Zone 21&22

Explosion-proof Electrical Equipment

Class I Division 1&2
Class II Division 1&2
Zone 1&2, Zone 21&22

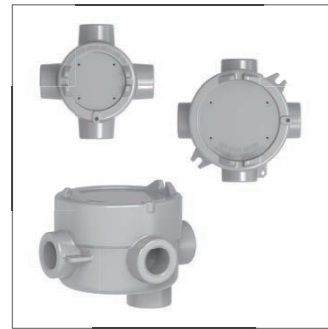

Junction Box
Series: EX-HD51
Voltage: Max.800V
Current: 24A, 32A, 41A
Degree of Protection: IP66/IP67
Class I Division 1&2
Zone 1&2, Zone 21&22



Cable Junction Box
Series: EX-HD51-KB1
Voltage: Max AC800V
Degree of Protection: IP66
Terminal block: Max.4
Cable entry: Max.5
2.5mm2/24A:
1/2" NPT/M20x1.5;
2. 5mm2/24A, 4mm2/27A:
3/4" NPT/M25x1.5
Class I Division 1; Zone 1



Installation Arm
Series: EX-HD51-KYD
Voltage: Max AC800V
Degree of Protection: IP66
Terminal block: Max.4
Cable entry: Max.4
2.5mm2/24A:
1/2" NPT/M20x1.5;
2.5mm2/24A, 4mm2/27A:
3/4" NPT/M25x1.5
Class I Division1; Zone 1

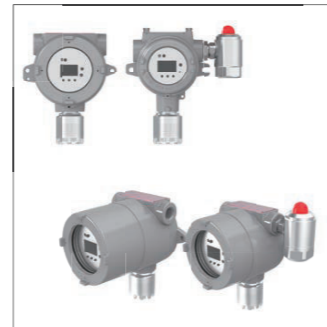

Gas Detector IN01
Series: EX-IN01-A/B/C/D
Working Temperature:
-60°C to 70°C /-60°C to 85°C
-76°F to 158°F /-76°F to 185°F
Voltage: DC24V
Degree of Protection: IP66
Class I Division 1&2
Class II Division 1&2
Zone 1&2, Zone 21&22



Lighting Control Sensor (Motion Sensor)
Series: EX-IN01-B-MS/OS/MO
Voltage: AC120-277V, 50Hz
Degree of Protection: IP66/67
Class I Division 1&2
Class II Division 1&2
Zone 1&2, Zone 21 &22



Lighting Control Sensor (Motion Sensor)
Series: EX-IN02-MS/OS/MO
Working Temperature:
-25°C ~ 60°C(-13°F~ 140°F)
Voltage: AC120-277V
AC120-347V
Degree of Protection: IP66
Class I Division 2
Class II Division 1&2
Zone 1&2, Zone 21

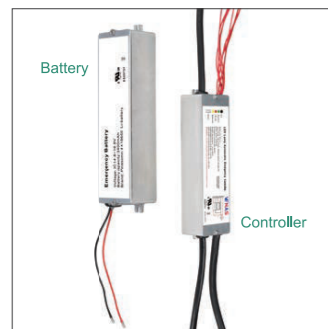

TGA(Controller+Battery)
Controller: EM-15W-HL(A)
Battery: EM-15W-HL(B)
Emergency Pack for
A,A3,A4,
B,B3, B4,
C,C3,D,
H,I,STA,
R Series Luminaires
UL924, UL844, IEC60079
Class I Division 1&2
Class II Division 1&2
Zone 1&2, Zone 21 &22

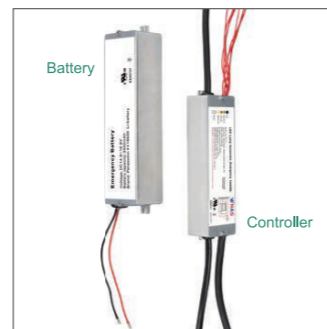

EX-PROOF Emergency Power
Input: AC100-277V, 50/60Hz
0.5A Max.
9W Max.
Output: DC42-50V,
300mA Max.
15W Max.
Emergency Time: Min. 90 min
Li-ion Battery: 14.8V 2000mAh
UL924, UL 844, IEC60079
Class I Division 1&2
Class II Division 1&2
Zone 1&2, Zone 21 &22

Explosion-proof Electrical Equipment

Class I Division 1
Zone 1&2, Zone 21&22



EX-PROOF iPhone14
Series: EX-MP
Charger: AC100-240V, 50/60Hz
Dimension: 107x180x30mm
Net Weight: 672 grams
Protection: IP66/IK08
Class I Division 1
Zone 1&2



Indicators
Series: EX-D
Voltage: AC400V, 50/60HZ
AC220-415V, 50/60HZ
DC220V, AC/DC48-120V
AC/DC12-36V
IP66-IP67
Zone 1&2, Zone 21&22



Control Switch
Series: EX-K
Voltage: Max. AC500V
DC400V
Current: 16A, 25A
Degree of Protection:
IP66-IP68
Ambient Temperature:
-60°Cto +100°C
Zone 1&2, Zone 21&22



Flexible Conduit
Series: EX-NG
Connection Thread:
1. Metric thread
2. NPT or other thread(optional)
Ambient temperature:
-60°C to +80°C
Type: F/F, M/F, M/M
Zone 1&2, Zone 21&22



Connector
Series: EX-GJ
Structure type: F/F, M/M, M/F
Current: 16A, 32A, 63A,
125A (optional)
Degree of Protection: IP66-IP68
Ambient Temperature:
-60°Cto + 100 °C
Zone 1&2, Zone 21 & 22



Cable Glands
Series: EX-QM
Seal type: Single seal/Double Seal
Suitable for:
Armored cable/Unarmored cable
Entry thread: Metric or NPT
Degree of Protection: IP66-IP68
Zone 1&2, Zone 21&22



Installation Switch
Series: EX-ZM
Voltage: Max. AC690V
Current:16A,25A
Degree of Protection: IP66
Zone 1&2, Zone 21&22



Control Unit System
Series: EX-ZA65
Optional Kit: Indicator/Switch/
Ammeter/Voltmeter
Degree of Protection: IP66
Zone 1&2, Zone 21&22

Explosion-proof Electrical Equipment

Zone 1&2, Zone 21&22



Alloy Plug and Socket
Series: EX-CZ81-16/32/63/125
Current: 16A,32A,63A,
125A(optional)
Degree of Protection: IP66/IP67
Zone 1&2, Zone 21&22



GRP Plug and Socket
Series: EX-CZ81-16/32/63/125
Current: 16A,32A,63A,
125A(optional)
Degree of Protection: IP66
Zone 1&2, Zone 21&22



Seal Bushings
Series: EX-AG
Connection Thread:
1. Metric thread
2. NPT or other thread(optional)
Degree of Protection: IP66/IP67
Zone 1&2, Zone 21&22



Instrument Enclosure
Degree of Protection: IP66/67
Class I Division 1&2
Zone 1&2, Zone 21&22
Class I Division 1&2
Class II Division 1&2
Zone 1&2, Zone 21&22



Distribution Equipment
Series: EJB
Voltage: Max. AC800V
50/60Hz
Current: 415A
Degree of Protection: IP66
Zone 1&2, Zone 21 &22



Distribution Equipment
Series: EX-PD61
Voltage: Max. AC800V
50/60Hz
Current: 415A
Degree of Protection: IP66
Zone 1&2, Zone 21&22



Stainless Steel Terminal Box
Series: EX-PD62
Voltage: Max AC1100V
Current: 24A/32A/41A
57A/76A/11 5A/126A/
184A/218A/265A/350A
Degree of Protection: IP66
Zone 1,2, Zone 21,22



GRP Terminal Box
Series: EX-PD65
Voltage: Max .AC690V
Current: 24A/32A/41A/57A/76A/125A
Degree of Protection: IP66
Zone 1,2, Zone 21,22

Explosion-proof Electrical Equipment

Zone 1&2, Zone 21&22



Control Switch
Series: EX-PD66
Voltage: Max .AC690V
Current: 24A/32A/41A/57A/76A/125A
Degree of Protection: IP66
Zone 1,2, Zone 21,22



Pushbuttons
Series: EX-A
Connection Thread: Metric thread
Ui: 690V; Ith=10A
Power: ≤3W
Degree of Protection:
IP66-IP67
Ambient Temperature:
-60°C to +100°C

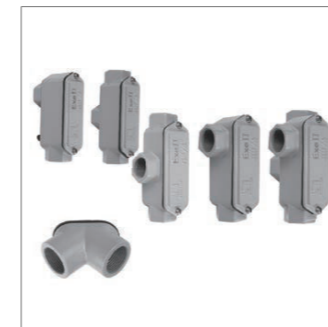

Alloy Bushings
Series: EX-HC
Connection Thread:
1. Metric thread
2. NPT or other thread(optional)
Thread Pitch:
Metric thread: 15mm
Other thread: Customizable
Ambient Temperature: -60°Cto +70°C